



# **Department of Transport**

## **K53**

### **Practical driving test for motor vehicle drivers**

#### **Volume 1**

#### **Light Motor Vehicle**

#### **Code B**

**August 2005**

**REQUIREMENTS RELATING TO THE TECHNICAL DATA**

1. A 1 metre clear-space shall be required around each yard test manoeuvre.
2. All positions for obstacles shall be clearly marked.

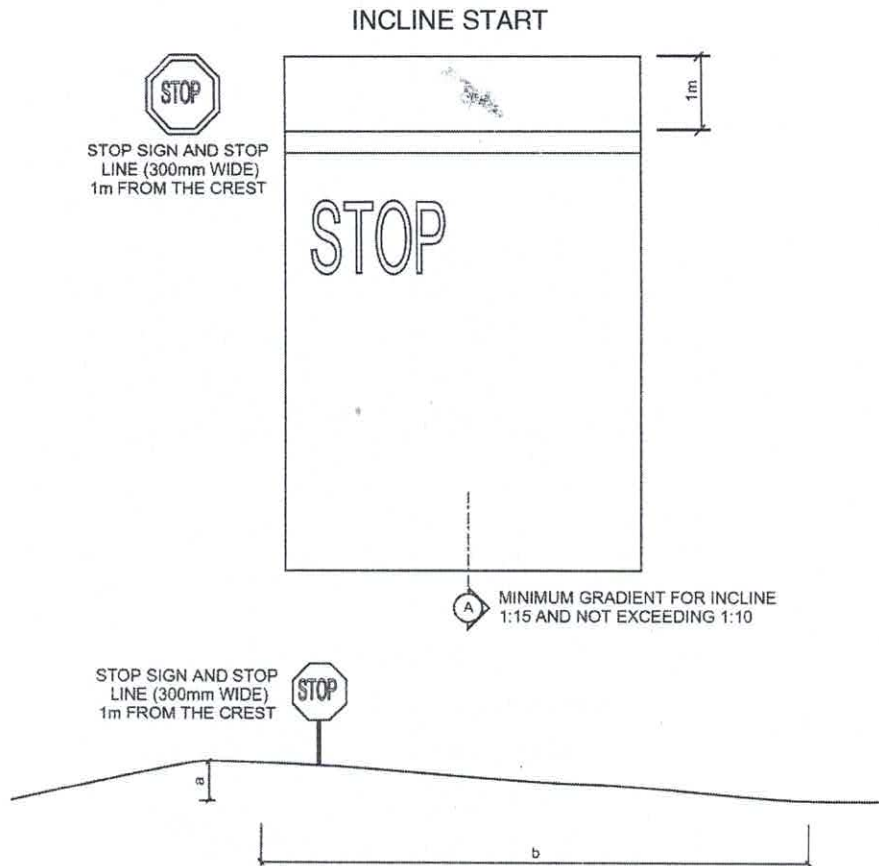
**EXAMPLE**

IF  $b = 10\text{m}$  AND  $a = 666\text{mm}$  GRADIENT = 1:15

IF  $b = 10\text{m}$  AND  $a = 1000\text{mm}$  GRADIENT = 1:10

**NOTE:**

1. PAINTED LINES – COLOUR OF CHOICE.
2. STOP LINE TO BE 300 mm WIDE.
3. ALL OTHER PAINTED LINES TO BE 100 mm.

TURN IN THE ROAD

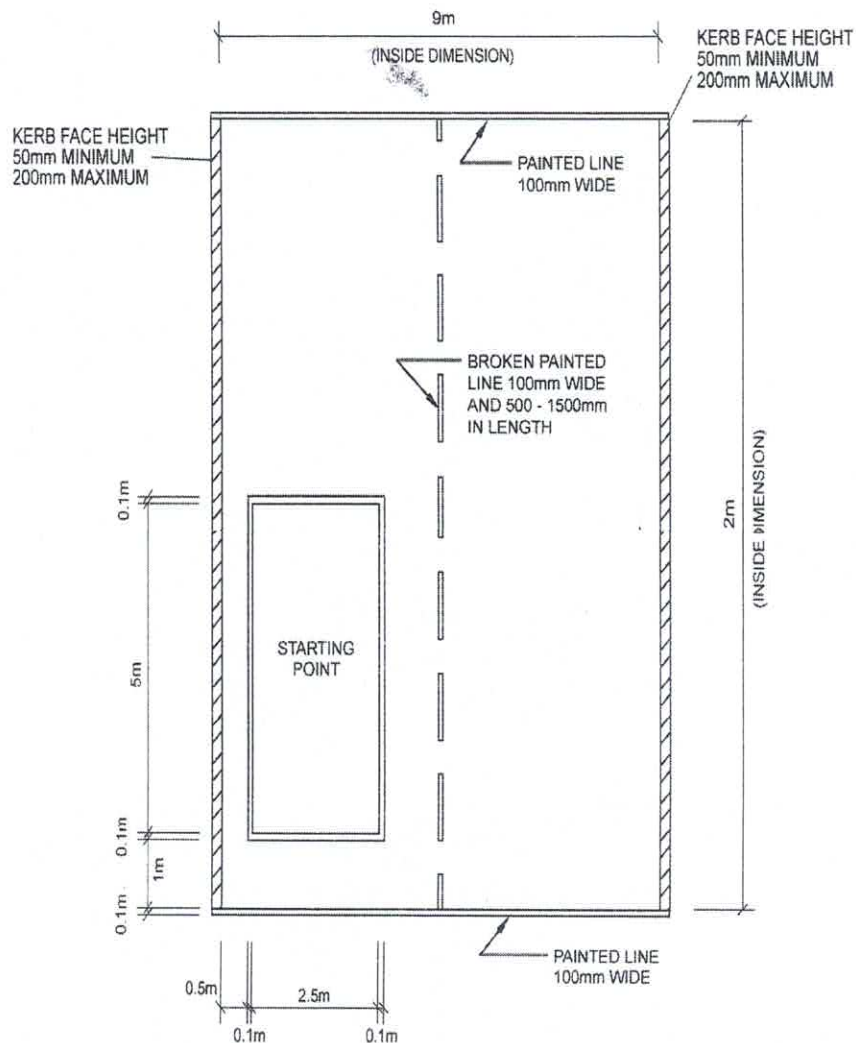

NOTE:

1. PAINTED LINES - COLOUR OF CHOICE.
2. ALL PAINTED LINES TO BE 100mm.

## ALLEY DOCKING

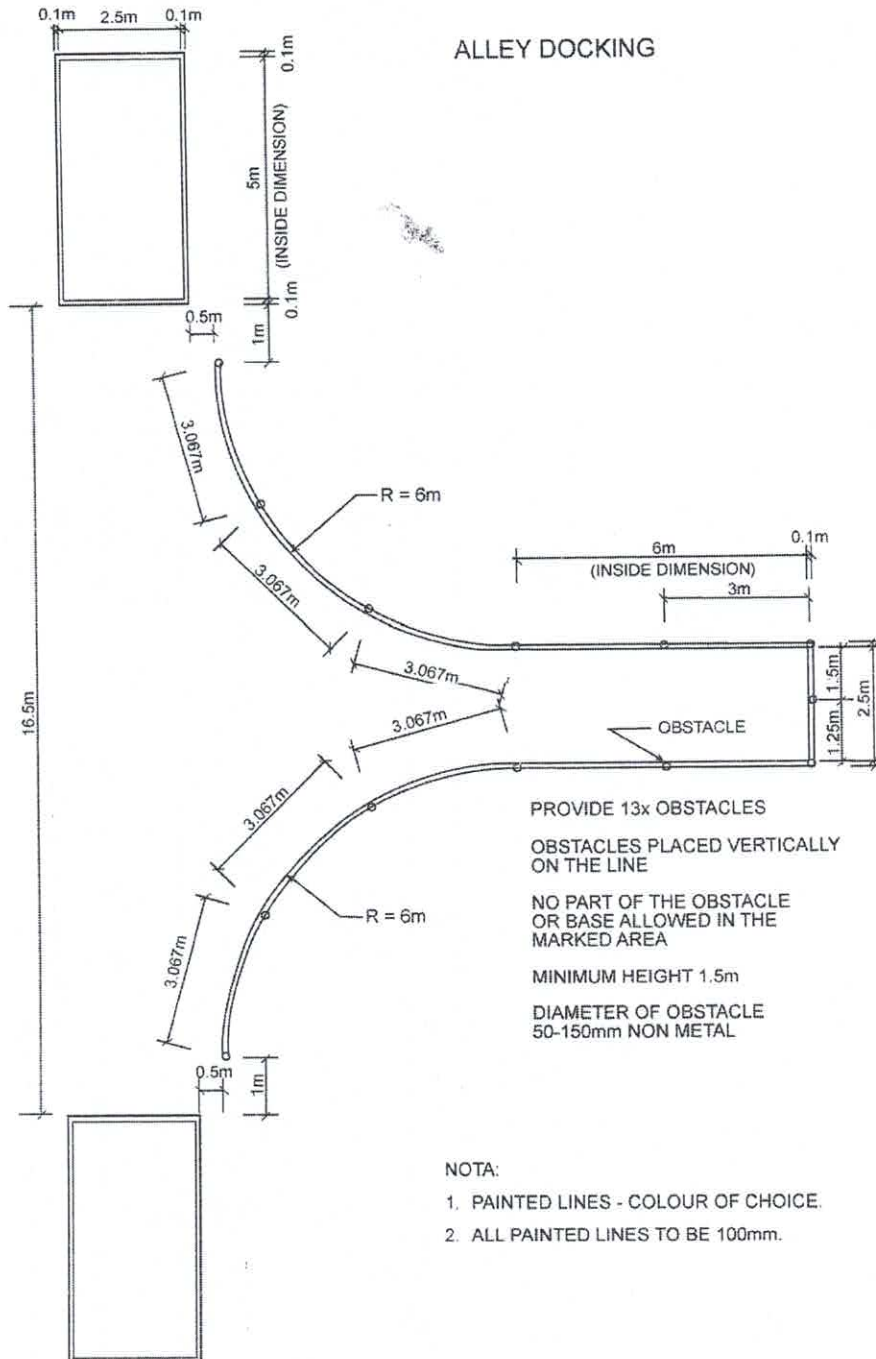

## PARALLEL PARKING

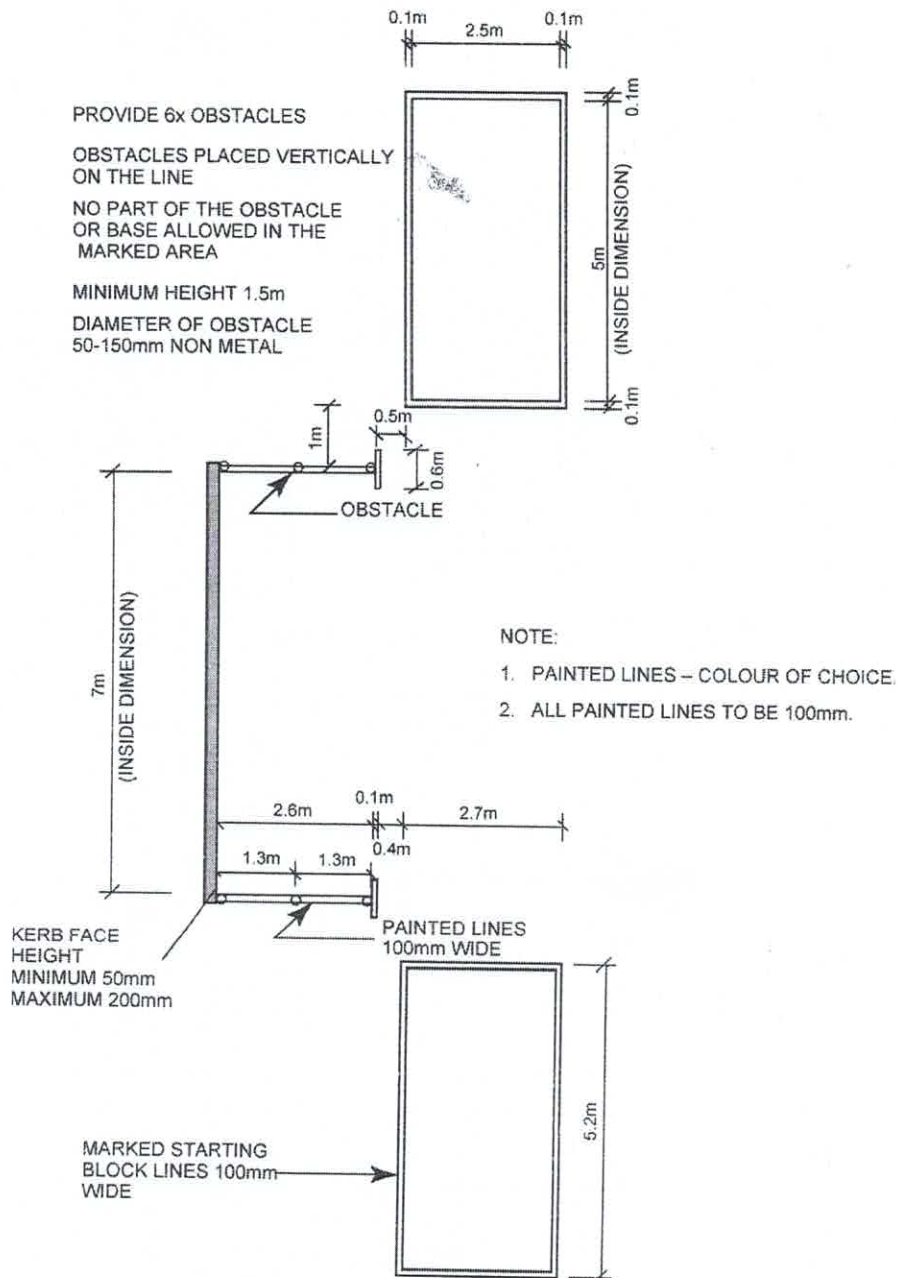



# **Department of Transport**

## **K53**

### **Practical driving test for motor vehicle drivers**

#### **Volume 2**

#### **Heavy Motor Vehicles**

#### **Codes C1, C, EC1 and EC**

**August 2005**

## REQUIREMENTS RELATING TO THE TECHNICAL DATA

1. A 1 metre clear-space shall be required around each yard test manoeuvre.
2. All positions for obstacles shall be clearly marked.

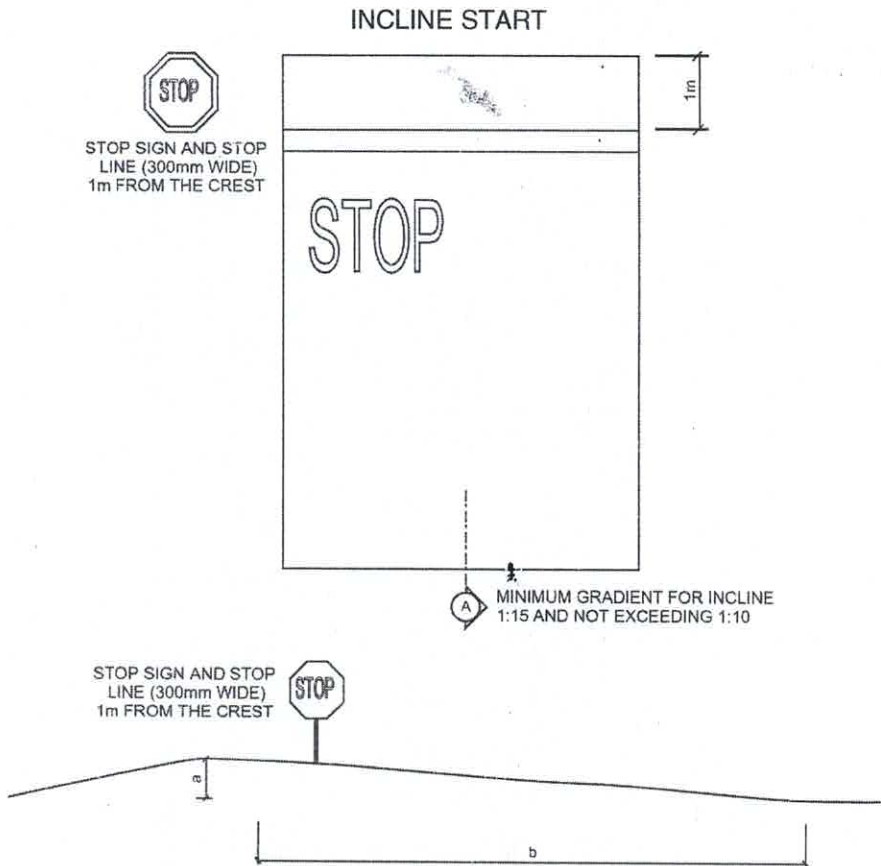

### EXAMPLE

IF  $b = 10\text{m}$  AND  $a = 666\text{mm}$  GRADIENT = 1:15

IF  $b = 10\text{m}$  AND  $a = 1000\text{mm}$  GRADIENT = 1:10

### NOTE:

1. PAINTED LINES – COLOUR OF CHOICE.
2. STOP LINE TO BE 300 mm WIDE.
3. ALL OTHER PAINTED LINES TO BE 100 mm.

## ALLEY DOCKING

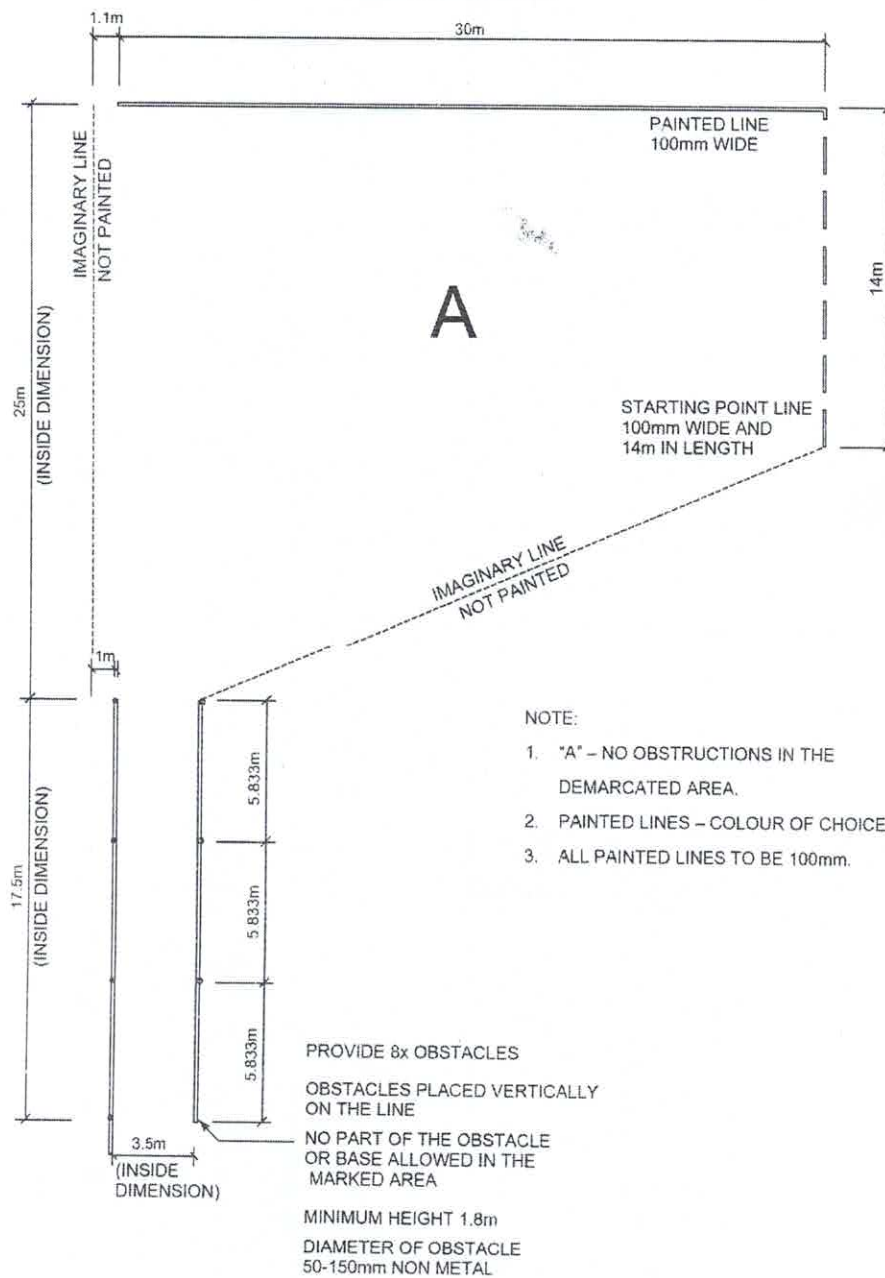



LEFT TURN

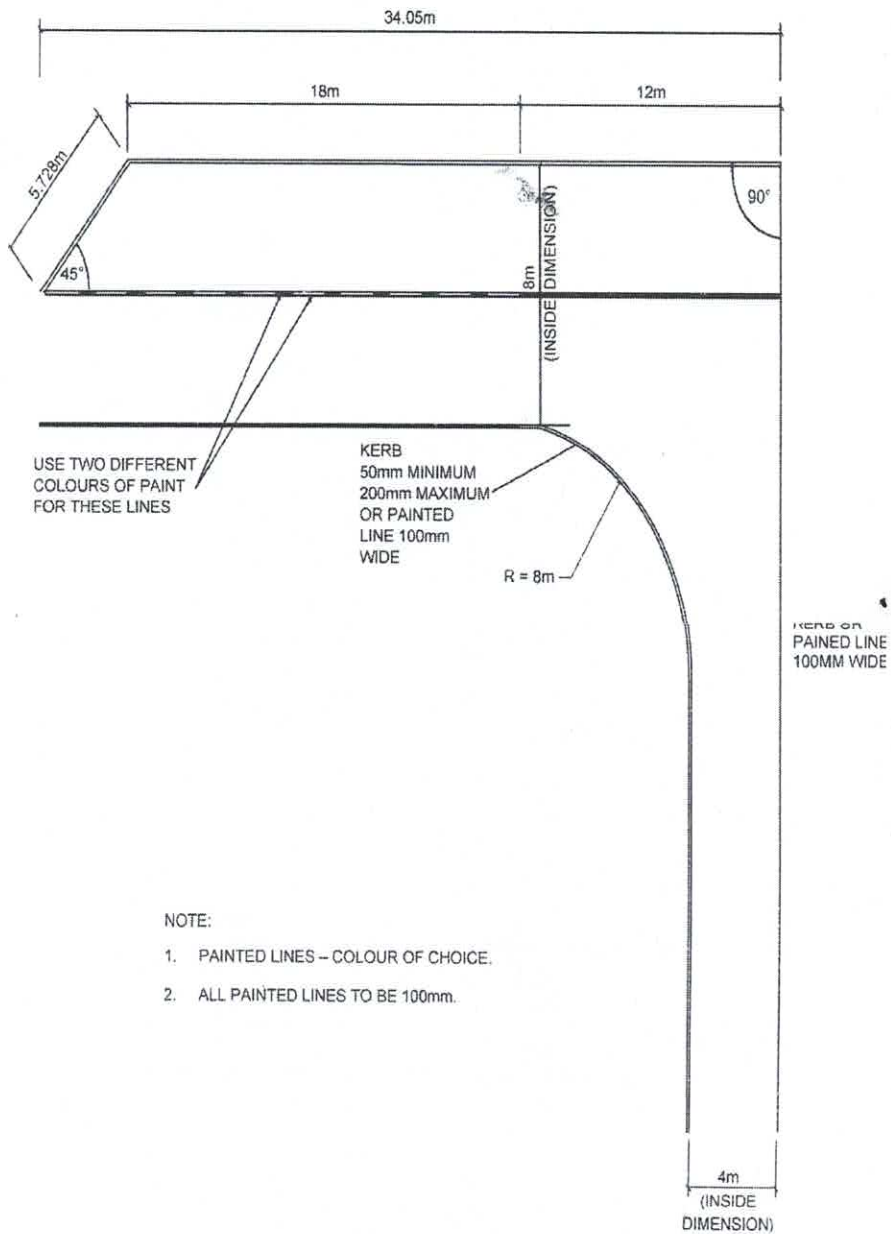

NOTE:

1. PAINTED LINES – COLOUR OF CHOICE.
2. ALL PAINTED LINES TO BE 100mm.

REVERSE IN A STRAIGHT LINE

NOTE:

1. PAINTED LINES – COLOUR OF CHOICE.
2. ALL PAINTED LINES TO BE 100mm.

PAINTED LINE  
100mm WIDE

